Mounting Instructions

YAMAHA

1981 XJ 750 Seca

warning

THE HARDWARE DESCRIBED IN THIS MANUAL WAS DESIGNED TO MOUNT THIS VETTER FAIRING TO THE MOTORCYCLE(S) DESIGNATED.

If you are unable to determine if this hardware is for your motorcycle, contact your dealer. If your dealer is unavailable, contact the Vetter Corporation Customer Service Department, Rantoul, IL 61866, (217) 893-9300. These instructions contain valuable information for future reference. They must be given to the customer.

note:

This manual may cover several motorcycles and some illustration details may differ from yours. Follow the instructions.

Prepare for Fairing Installation

1. Put the motorcycle on its center stand. Remove the seat and gas tank to prevent damage and facilitate assembly.
2. Remove the phillips head screws in the headlight and remove the headlight.
3. Disconnect all the wiring block connectors inside the nacelle.
4. Remove the two 8mm bolts holding the nacelle to the headlight stays and the 6mm headlight adjustment bolt located at the bottom of the nacelle.

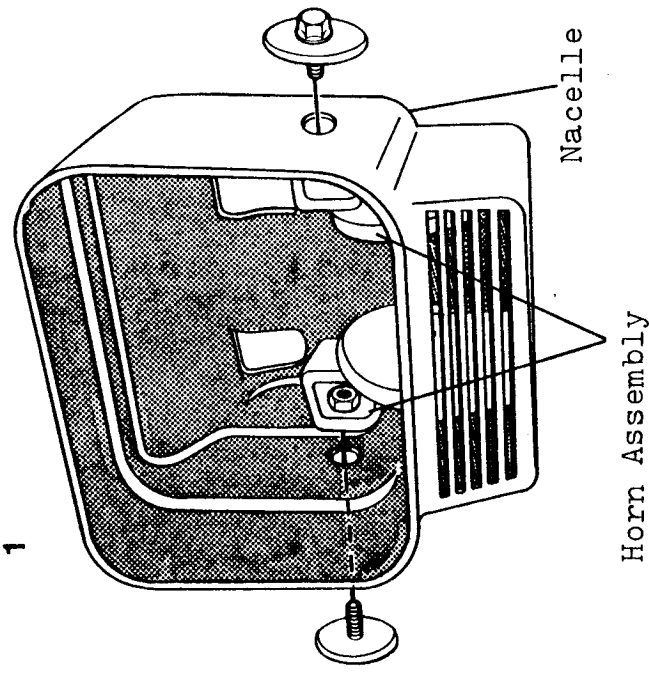

5. Remove the horn assemblies from inside the nacelle, then remove the nacelle, pushing the wires out the back. (Illus. 1)
6. Remove the 8mm nut and lock washer which hold the auxiliary light and remove it from its bracket.
7. Remove the two phillips head screws which hold the Yamaha nameplate and remove it.
8. Remove the allen screw and two 8mm bolts holding each turn-signal assembly, then remove the turnsignals. Reinstall the two 8mm bolts in the triple clamp and tighten to factory specifications.
9. Disconnect the tachometer cable at the instruments and let it hang for now.

note:

To provide proper clearance, it will be necessary to bend the headlight stays inward, routing the instrument cables to the outside of the bent stays. (Illus. 2)

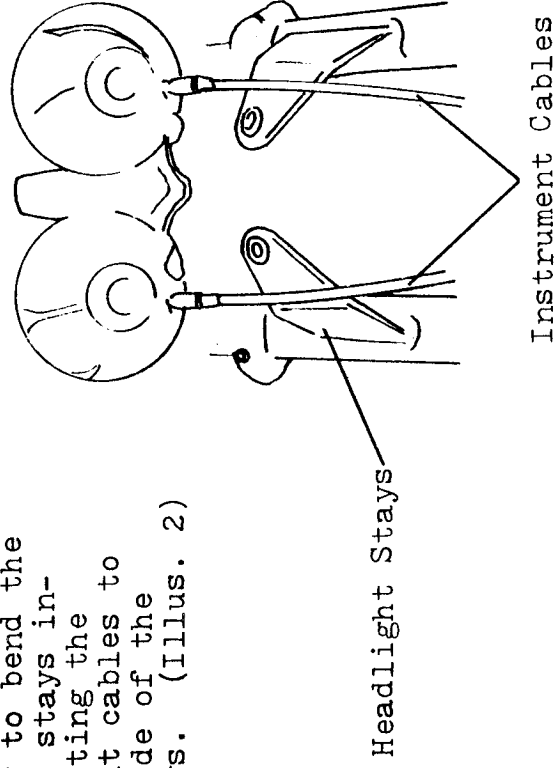

Install Mounting Bracket

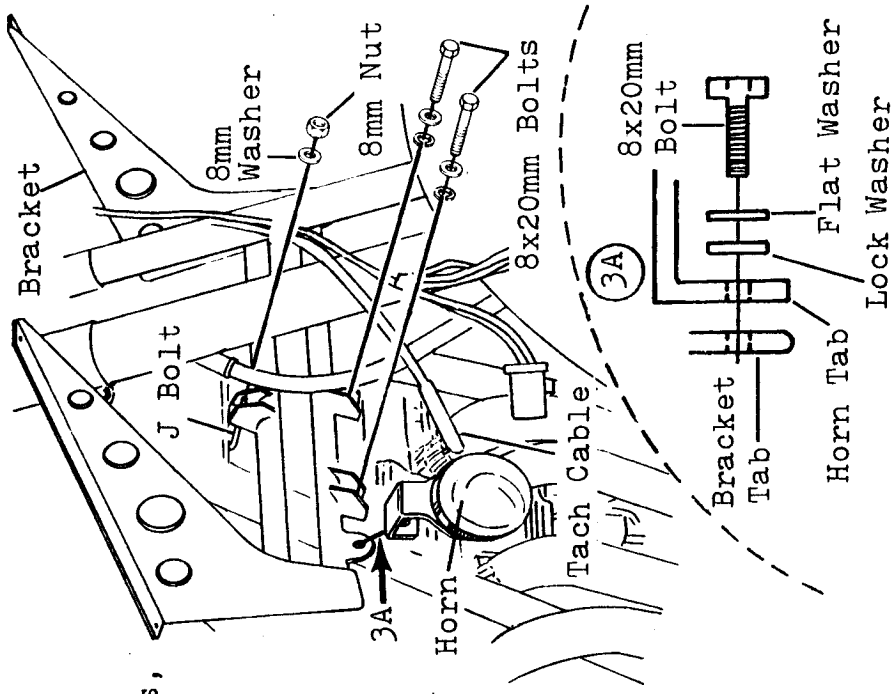

1. Position the hardware bracket on the frame as shown. (Illus. 3)
2. Install the supplied 8x20mm bolts, flat washers, and lock washers on the lower mounting tabs. Do not tighten.
3. Fit the J bolt to the frame and install the supplied 8mm nut and flat washer. Do not tighten yet. (Illus. 4)
4. Install the flat washers and lock nuts on the bolts. Do not tighten.
5. Check the bracket for horizontal alignment by viewing it from directly in front of the motor-cycle. If adjustment is necessary, tap the bracket into a level position.
6. Tighten the lower two mounting bolts and the J bolt using an alternating pattern until tight.
7. Reconnect the tachometer cable to the instruments.
8. Using the supplied 8x20mm bolts, flat washers, and lock washers, install the horns on the provided tabs on the hardware bracket. Reconnect the wires, using the four provided extension wires. (Illus. 3 & 3A)

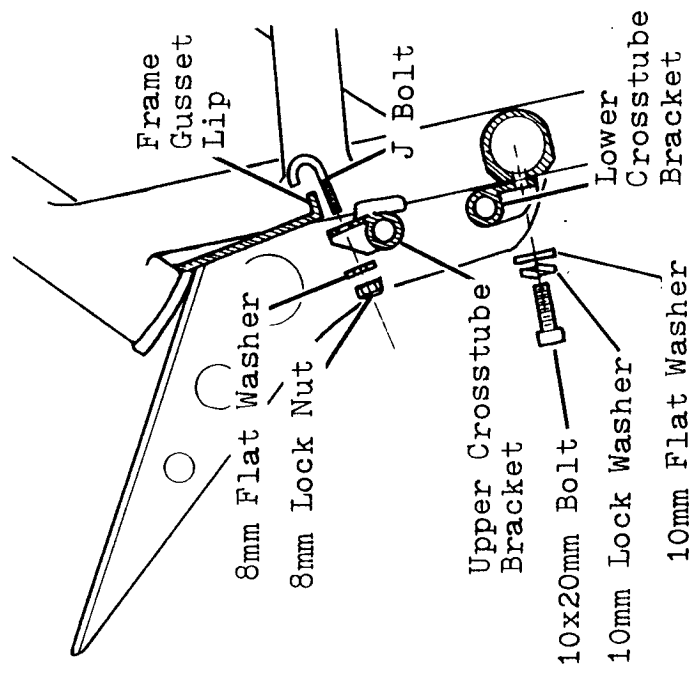

Electrical Connections

1. Temporarily hang the fairing on the mounting bracket as shown. (Illus. 5)
2. Refit all the wiring block connectors to their original counter-parts.
3. Route the Vetter wiring harness between the frame and left fork tube as seen from the seat. (Illus. 5) Attach the 3-prong plug in the harness to the motorcycle's headlight socket.

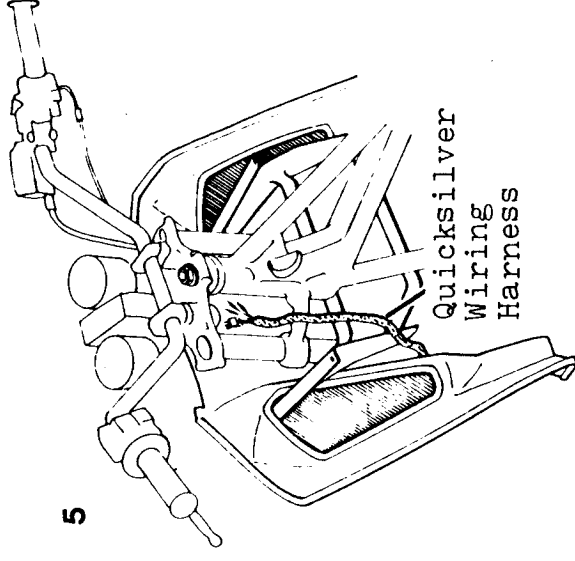

4. Connect the remaining wires, following the color code:

<u>Fairing</u>	<u>Function</u>	<u>Bike</u>
----------------	-----------------	-------------

Violet.....	Left Turnsignal.....	Brown
Blue.....	Right Turnsignal.....	Dark Green
Green.....	Running Lights.....	Light Blue

Plug the male bullets into the appropriate female connectors, making sure they are tight. A loose bullet connection can be improved by unplugging the male connector, making the female receptacle smaller by use of pliers and then reconnecting.

5. Cover all the wiring connectors with the black vinyl bag supplied. Cinch up the drawstring and place the bag upside-down to keep water out. Hook two ty-raps end to end and secure the bag to the wire harness going into the instrument panel.

Mount the Fairing

1. Prepare two of the four 6x25mm bolts with the provided aztec washers. (Illus. 6)
2. Set the fairing on the mounting rails and secure it at the rear mounting holes, using the prepared bolts. Tighten only until the fairing rests securely. Forward mounting rests will take place after turnsignal installation.
3. Thread the supplied reflectors into the holes provided in the side plates. (Illus. 7)
4. Replace the seat and the gas tank.

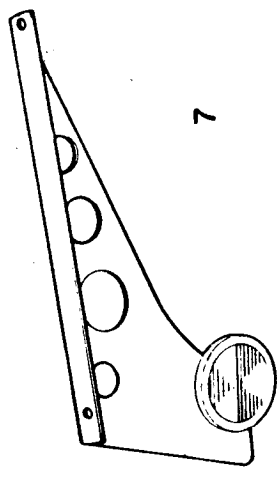
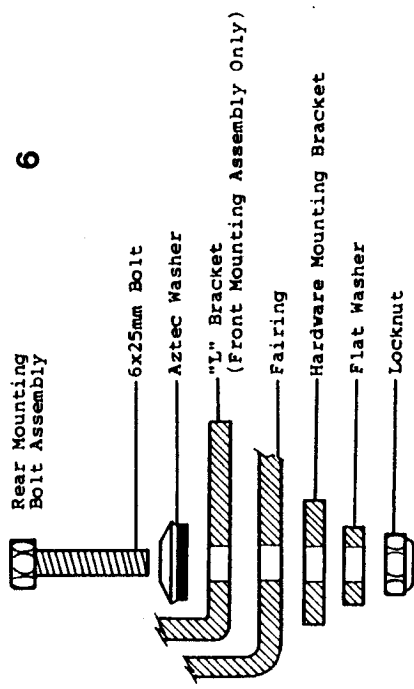

Refer to your Owner's Manual for turnsignal and windshield mounting instructions and final adjustments. We suggest you insert these instructions in the Owner's Manual for future reference.

USE THIS SCALE TO CHECK BOLT AND WASHER DIMENSIONS

