

1980 Honda CB-900 Custom

Windjammer IV Vindicator II Mounting Instructions

Dear Vetter Owner:

These instructions explain the procedure required to mount either the Windjammer IV or Vindicator II fairing to your motorcycle. We urge you to follow the preparation and assembly sequence from start to finish. This will benefit you directly in several ways: 1) You will be assured the fairing is properly installed and is immediately ready for operation. 2) You will minimize unnecessary confusion, moaning, and scraped knuckles. 3) You will protect your investment by doing it right, and 4) with the confidence that nothing has been overlooked, you won't have to waste time backtracking to correct mistakes. That's time you could spend riding.

Thanks for buying Vetter products. We appreciate your business and comments.

Sincerely,
The folks at Vetter

NOTE TO DEALERSHIP PERSONNEL: If you are installing the fairing, we ask that you adhere to this procedure. Following these instructions will help ensure that your customer remains a customer.

Table of Contents

Prepare the Motorcycle	2
Engine Guards	4
Install Mounting Bracket	5
Electrical Connections	7
Mount the Fairing	8
Vindicator Turn Signals	9

WARNING

THIS BRACKETING AND THESE INSTRUCTIONS WERE DESIGNED SOLELY FOR USE IN MOUNTING THE VETTER WINDJAMMER IV AND VINDICATOR II FAIRINGS TO THIS SPECIFIC MOTORCYCLE. IF YOU ARE UNABLE TO DETERMINE IF THIS HARDWARE IS FOR YOUR MOTORCYCLE, CONTACT YOUR DEALER. IF YOUR DEALER IS UNAVAILABLE, CONTACT THE CUSTOMER SERVICE DEPARTMENT, VETTER CORPORATION, RANTOUL, ILLINOIS 61866 (217/893-9300). THESE INSTRUCTIONS CONTAIN VALUABLE INFORMATION FOR FUTURE REFERENCE. THEY MUST BE GIVEN TO THE CUSTOMER.

prepare the motorcycle

- 1) Put the motorcycle on its centerstand. Remove the two phillips head screws in the headlight rim, remove the rim and pull the headlight forward. Disconnect the 3-prong plug and remove the headlight.
- 2) Unscrew the reflectors. Put the reflectors aside to be remounted.
- 3) Disconnect the turn signal wires on each side: Left-Orange, Orange/White, Green; Right-Blue, Blue/White.
- 4) Disconnect the speedometer cables. Unplug all the wiring block connectors. Remove the headlight shell from the stays and pull the wiring harness back through the access holes. Remove the nacelle. It will not be reused.
- 5) Remove the nut and bolts holding the turn signals to the stocks. Pry open the slot on the turn signal housing with a screw driver, and pull the housing away and off the stock.

CAUTION

REMOVE THE TURN SIGNALS CAREFULLY. PULLING TOO HARD ON THE WIRES WILL BREAK THE CONNECTIONS AT THE BULB.

If you are installing a Vindicator, put the turn signals aside to be remounted.

- 6) Remove the motorcycle gas tank to prevent damage during installation and to facilitate assembly.

NOTE:

In order to provide proper clearance for turning the forks with the fairing installed, it will be necessary to remove the headlight stays from the tubes.

- 7) Remove the four plastic caps covering the handlebar clamp bolts. Remove the four allen head screws and lift off the handlebar clamp fuse box holder unit. Lift up and over the ignition switch. Rotate the assembly to the left and carefully let it hang for now.

NOTE: Bleed air out of forks before removing hose.

- 8) Remove the air suspension hose at the top of the forks on both sides. Remove the fitting on the left fork cap where the hose was connected. (Illus. 1)

*area of interest is enlarged

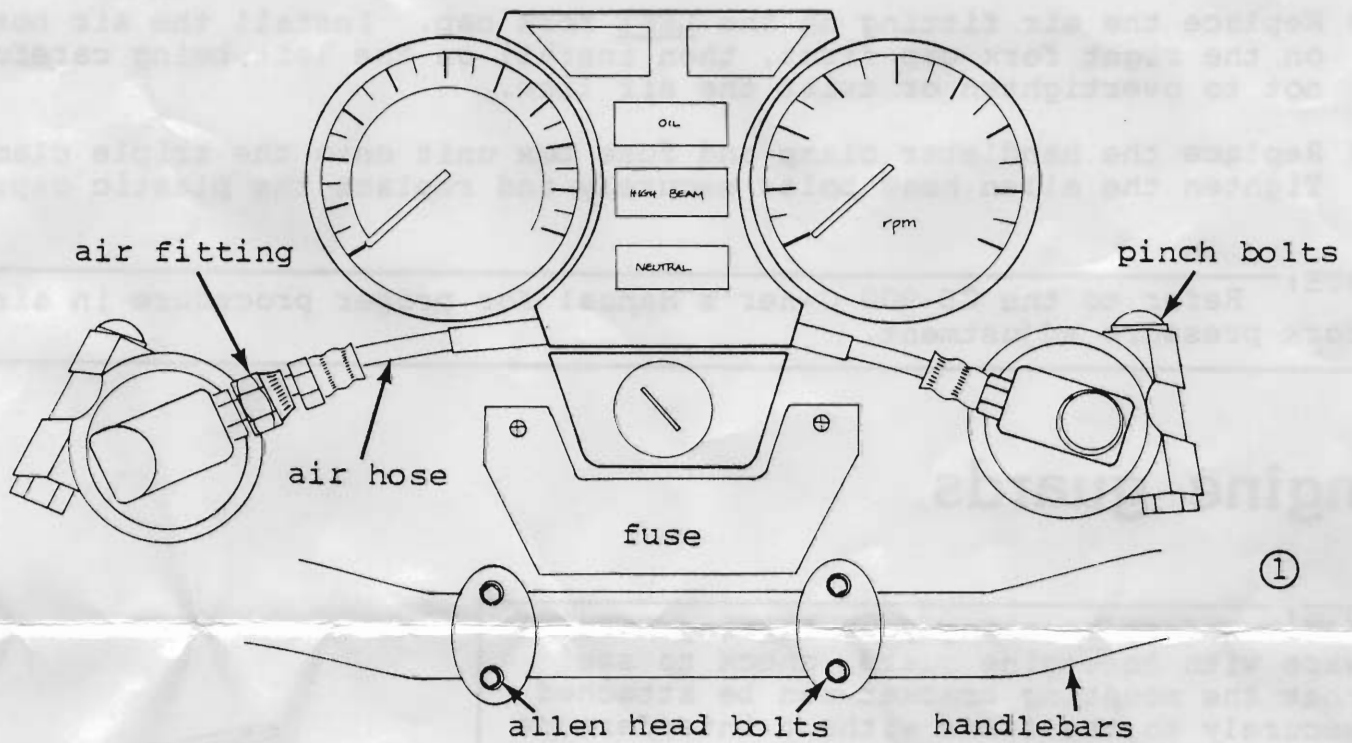

- 9) Remove the large chrome cap nut and the two pinch bolts on the upper triple clamp.
- 10) Bolt the handlebars back into place, but do not tighten since they will be removed again.
- 11) Lift the triple clamp and handlebar assembly straight up and off, being careful not to damage the instrument.
- 12) Move the triple clamp assembly to one side. Pull the chrome headlight stay off along with the rubber grommets. Move the triple clamp to the other side and remove the other headlight stay along with its rubber grommets.
- 13) Place the triple clamp back into position, but do not tighten pinch bolts yet.

NOTE: To aid reinstallation of the triple clamp, coat the fork tops and the threaded area of the steering stem lightly with grease.

- 14) Remove the bolts holding the handlebars, then remove the handlebars. Install chrome cap nut and tighten securely. Tighten pinch bolts securely.
- 15) Replace the air fitting on the LEFT fork cap. Install the air hose on the right fork cap first, then install on the left being careful not to overtighten or twist the air line.
- 16) Replace the handlebar clamp and fuse box unit onto the triple clamp. Tighten the allen head bolts securely and replace the plastic caps.

NOTE: Refer to the CB-900 Owner's Manual for proper procedure in air fork pressure adjustment.

engine guards

NOTE: Before mounting your fairing hardware with an engine guard, check to see that the mounting bracket can be attached securely to the frame without interference from the engine guard.

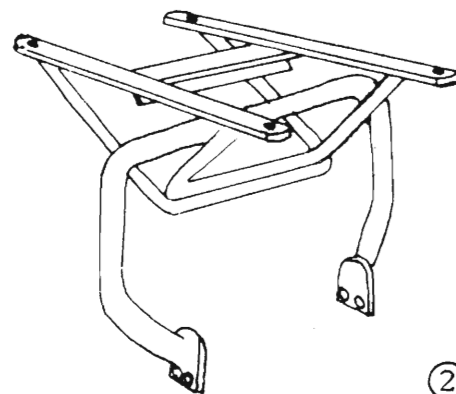

- 1) Mark the position of the upper engine guard mount on the motorcycle frame.
- 2) Remove the engine guard and position the mounting hardware on the frame. The hardware should clear all marks that locate the upper engine guard mount.
(Illus. 2)

WARNING

IF IT IS OBVIOUS THAT THE MOUNTING BRACKET AND ENGINE GUARD CANNOT BE USED TOGETHER, DO NOT ATTEMPT TO MOUNT THE FAIRING WITH THE ENGINE GUARD. IF THERE IS NO APPARENT INTERFERENCE, CONTINUE WITH THE APPROPRIATE SECTION.

install mounting bracket

- 1) Pull pin out of oil cooler bottom mount.
- 2) Remove the two 6mm cap nuts which hold the oil cooler to the frame down tubes. (Illus. 3)

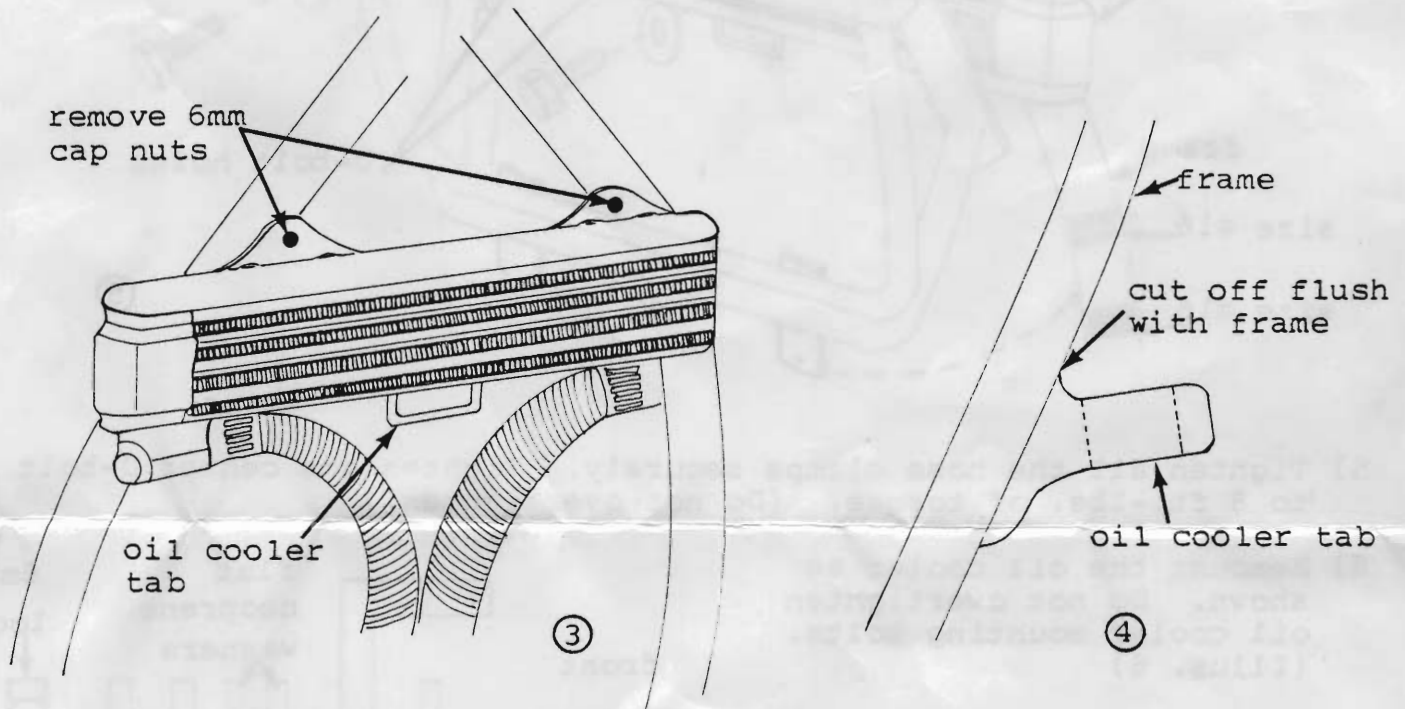

- 3) Lifting the oil cooler forward and up, remove it from the frame and let it hang to one side being careful not to damage any oil lines.

NOTE: To provide proper clearance for the oil cooler, the lower mounting tab must be cut off flush with the frame. Failure to do so will result in damage to the oil cooler and engine. (Illus. 4)

- 4) Install the bracket on the frame using the following illustration. Thread the oil cooler between the center of the bracket so that the oil lines are behind the bottom of the bracket's cross tubes. The oil cooler will be remounted later. Use the provided hose clamps and U-bolts to mount the fairing. DO NOT TIGHTEN. (Illus. 5, next page)

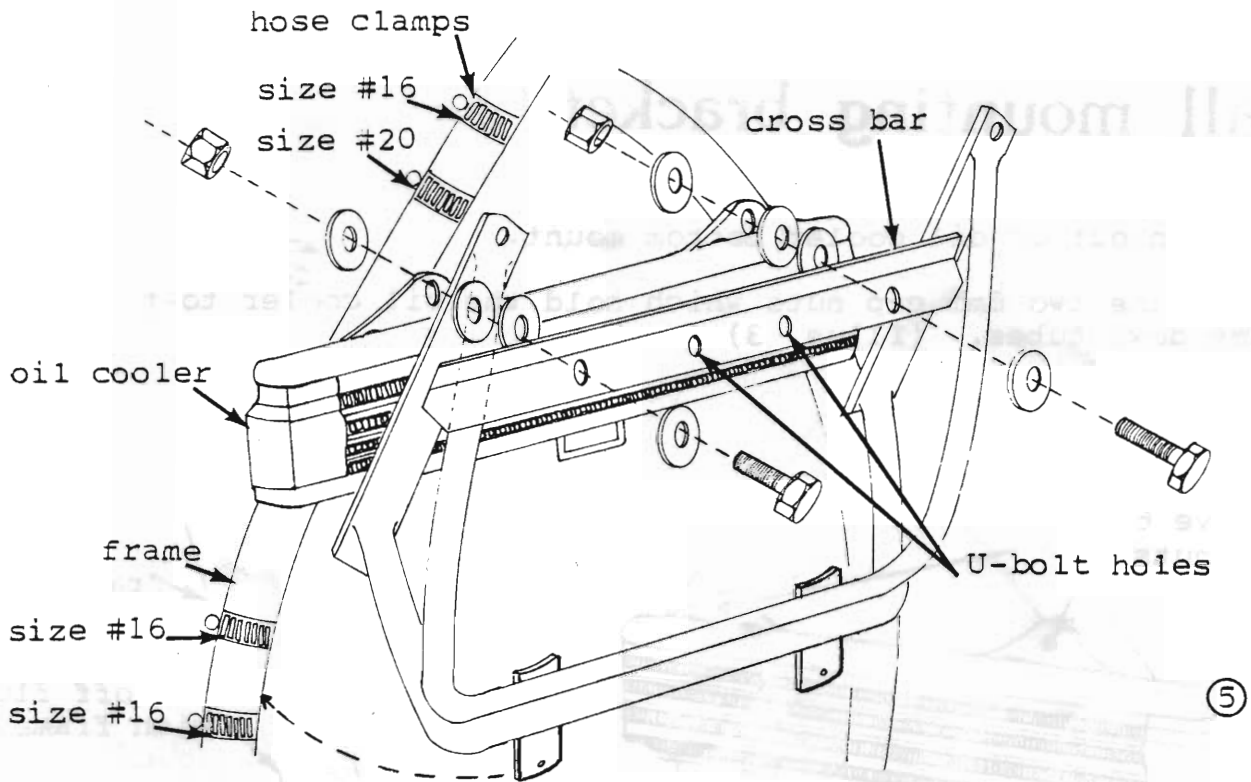

- 5) Tighten all the hose clamps securely. Tighten the center U-bolt to 8 ft.-lbs. of torque. (Do not overtighten.)
- 6) Remount the oil cooler as shown. Do not overtighten oil cooler mounting bolts. (Illus. 6)
- 7) Recheck all mounting hose clamps for tightness.

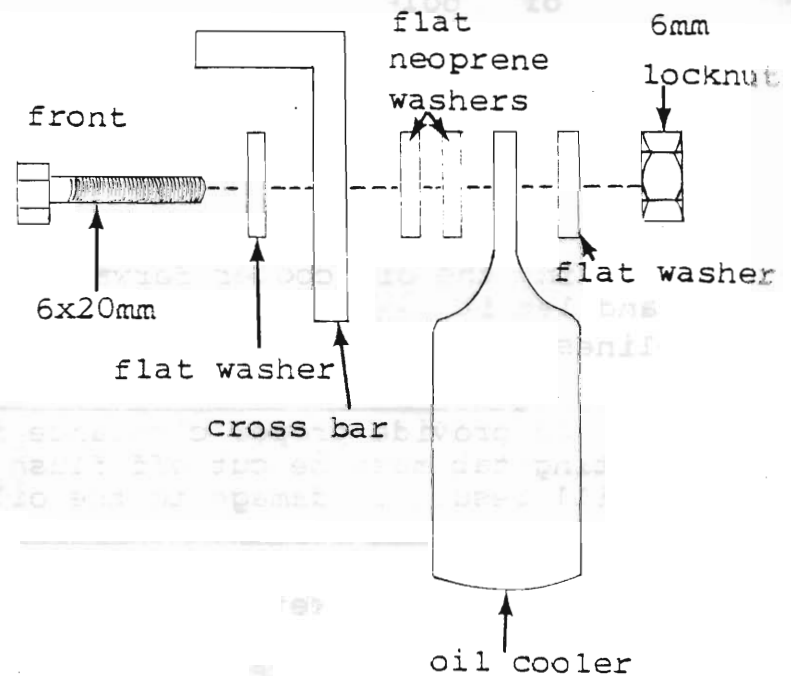

electrical connections

- 1) Refit all the wiring block connectors to their original counterparts.
- 2) If the optional horns ARE installed in the fairing, do not reconnect horn wires to horn.
- 3) Route the Vetter wiring harness between the frame and left fork tube. Attach the 3-prong plug in the harness to the motorcycle's headlight socket.
- 4) Connect the remaining wire following the color code below:

<u>Fairing Wire</u>	<u>Function</u>	<u>Bike Wire</u>
White	High Beam	Dark Blue
Yellow	Low Beam	White
Black	Ground	Green
Violet	Left Turn Signal	Orange
Blue	Right Turn Signal	Light Blue
Green	Running Lights	Brown/White
Red	Lighter	Black
Brown	Accessory (Horn option)..	Battery Wire(+)
Orange	Accessory (Horn option)..	Light Green

WARNING

THE ORANGE, BROWN, AND RED FAIRING WIRES ARE CONNECTED AS ABOVE ONLY FOR THE ACCESSORIES LISTED. ANY UNUSED WIRING SHOULD BE TAPED OFF AT THE END. BEFORE USING THESE WIRES FOR ANY OTHER ACCESSORIES, MAKE SURE YOUR MOTORCYCLE'S ELECTRICAL SYSTEM WILL TOLERATE THE EXTRA CURRENT DEMAND.

Plug the male bullets into the appropriate female connectors. Gently pull all connectors to make sure they are tight. If not, crimp the outside of the connectors with wire crimpers or pliers after the connection is made.

For wires without connectors, use the provided blue connectors as shown. (Illus. 7)

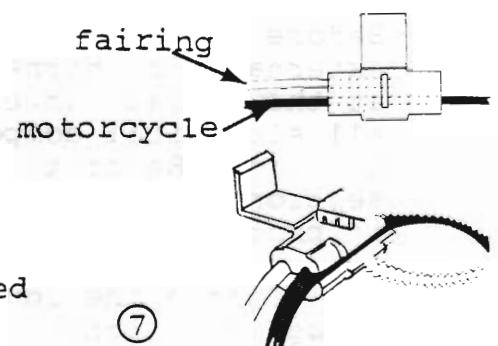

- A. Snap the blue connector over the appropriate motorcycle wire.
- B. Insert the appropriate fairing wire into the other hole.
The wire will not go all the way through the connector.
- C. Squeeze the metal tab down flush with the top of the connector.
- D. Fold the plastic lid down and snap it shut.

- 5) Cover all the wiring connectors with the black vinyl bag supplied. Cinch up the drawstring and place the bag upside-down to keep water

out. Hook two ty-raps end to end and secure the bag to the wire harness going into the instrument panel.

mount the fairing

NOTE: If you are planning to install Vetter color inserts, they should be applied before the fairing is mounted.

If you are installing the optional horns, refer to the instructions packaged with the horn kit. If not, proceed with the following steps.

VINDICATOR ONLY: Place the turn signal brackets on the support shelves. Tape the brackets in place to prevent movement when the fairing is being installed. (Illus. 8)

1) Prepare four 6x35mm bolts with flat washers and neoprene washers as shown. Insert the bolts in the mounting holes in the fairing.

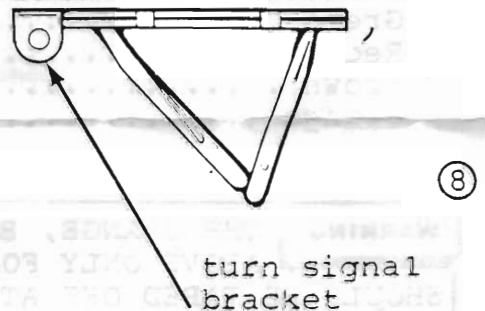

2) Set the fairing on the mounting bracket so the four bolts drop through the holes. Install lock nuts on the bolts, but do not tighten completely. (Illus. 9)

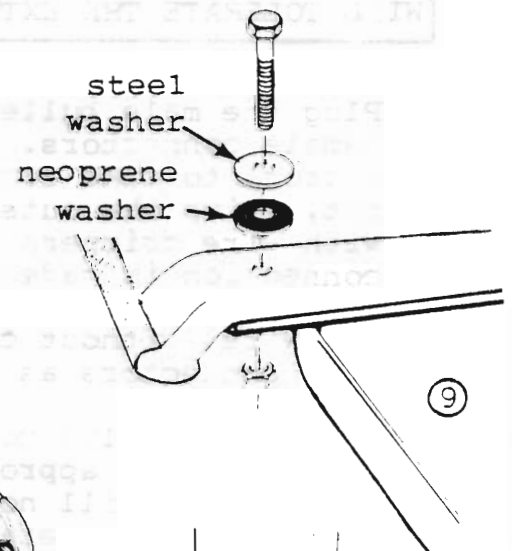

3) Before tightening the nuts, plug the external wire harness into the fairing at the serial number plate. Check all electrical components before continuing. Refer to the Troubleshooting section in your fairing Owner's Manual if problems arise.

4) Now tighten the four bolts enough to slightly compress the neoprene washers.

5) Fit the reflectors to the mounting clamps with the 6mm nuts provided.

6) Install each assembly on the fork slider as shown. (Illus. 10)

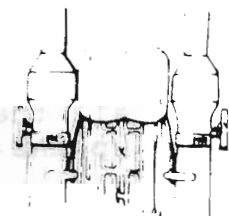
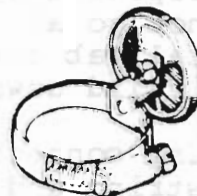

Refer to your Owner's Manual for windshield mounting instructions and final adjustments. We suggest you insert these instructions in the manual for future reference.

Vindicator turn signals

CUSTOM ONLY:

- 1) Remove the nuts and bolts holding the turn signals on the stalks. With a large screw driver in the slot, pry open the clamp enough to remove the turn signal. Carefully pull the wires completely through the stalk, and insert them through the Vetter stalk as shown. (Illus. 11)
- 2) Attach the turn signal to the stalk, and feed the wires through the support shelf, lock washer and hollow bolt. Secure the assembly to the support shelf and connect the wires to the appropriate fairing wires. Connect the ground wire to the tab on the bracket.
- 3) Pull the slack wire into the fairing by reaching through the side pocket. Carefully twist the wires to keep them inside the fairing.

