

Windjammer IV/ Vindicator II

Owner's Manual

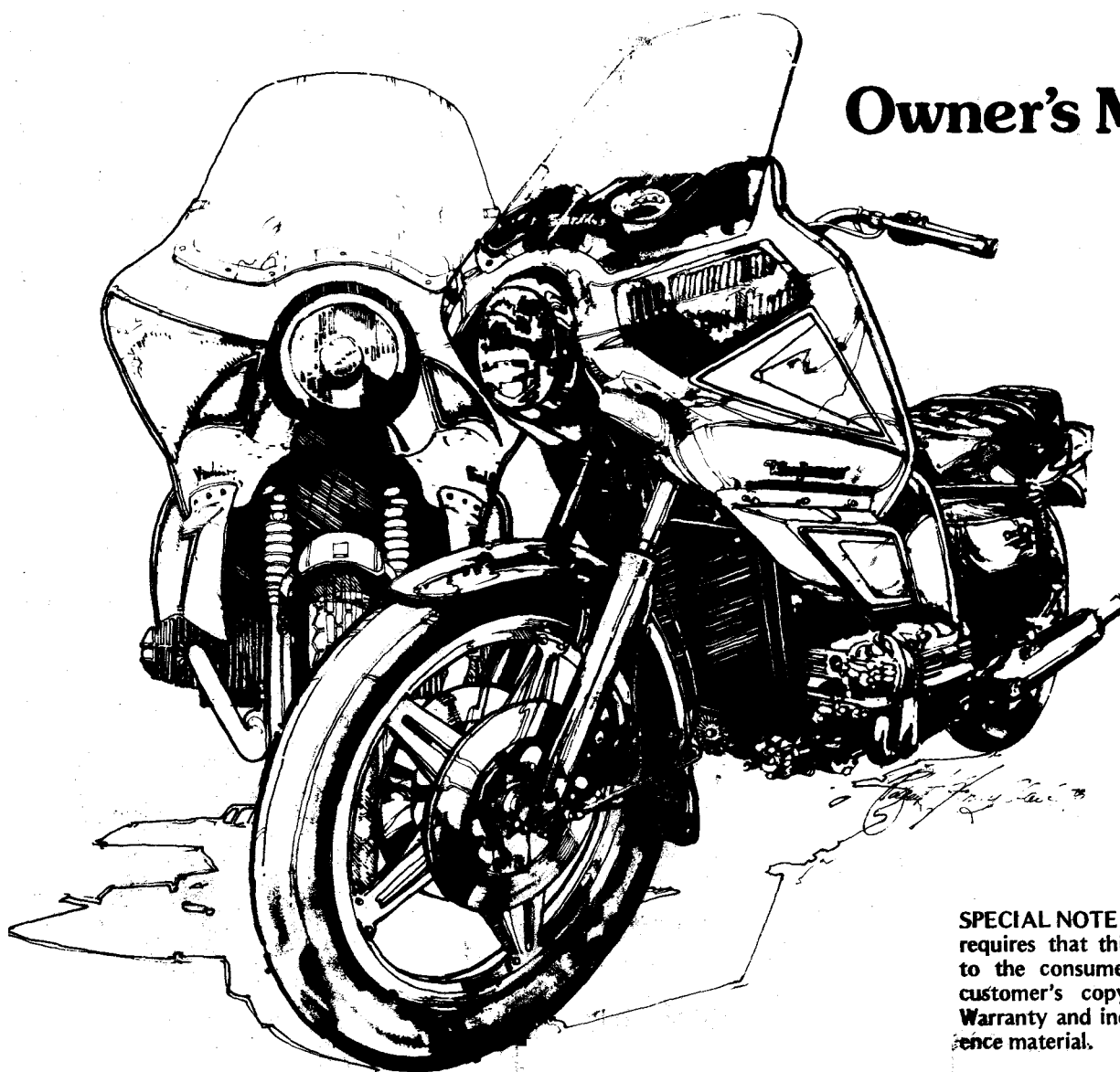

SPECIAL NOTE: Federal legislation requires that this manual be given to the consumer. It contains the customer's copy of the Limited Warranty and includes future reference material.

Vetter



Table of Contents

INTRODUCTION	3
WINDJAMMER IV NOMENCLATURE GUIDE	4
VINDICATOR II NOMENCLATURE GUIDE	5
WINDSHIELD INSTALLATION INSTRUCTIONS	6
FINAL ADJUSTMENTS	7
TROUBLESHOOTING	8
MAINTENANCE	8&9
WARRANTY	10

Introduction

This manual contains important information regarding the proper installation, safe operation and maintenance of your Windjammer IV or Vindicator II fairing (Vetter Windjammer and Vindicator fairings share most components and will be referred to as Vetter Fairings henceforth). We urge you to read this manual completely, understand all components of your fairing and follow the recommendations to obtain the most trouble-free and enjoyable operation of your fairing.

In this manual and in the mounting instructions, statements preceded by the following words are of special significance:

WARNING: means that there is the possibility of personal injury to yourself and others.

CAUTION: means that there is the possibility of damage to the fairing and related components.

NOTE: indicates points of particular interest for more efficient and convenient installation and operation.

We recommend that you take particular notice of these items when reading this manual and the mounting instructions.

The intent of this manual is to insure that your Vetter fairing is properly installed and to provide necessary maintenance information — PLEASE USE IT! First we recommend that as

you unpack your fairing you use page 3 or 4 to study and recognize the various parts. Second, we recommend that you study your Hardware Mounting Instructions included with the hardware or adaptor kit and insert them into this manual along with all other option instructions and packing lists for easy reference. Working straight through the Mounting Instructions is a way of assuring that nothing is overlooked or forgotten.

As you are following the instructions, double check the following points as they are critical:

1. Carefully check wiring color codes.
2. Always install rubber washers between steel washers and the fairing.
3. Check for clearance and tighten all bolts before operating your motorcycle with the newly installed fairing.
4. Periodically check and retighten all bolts and clamps after installation.

SPECIAL NOTE: Vetter Corporation reserves the right to make changes in design and specifications, and/or to make additions to or improvements in its products without imposing any obligations upon itself to add or install them on products previously manufactured or sold.

Windjammer IV Nomenclature Guide

INTERIOR

- Ear 1.
- Headlight adjustment knob 2.
- Pocket edging 3.
- Pocket tonneau 4.
- Locking tonneau 5.
- Horseshoe 6.
- Serial no. plate 7.
- Cigarette lighter hole 8.
- Lower mounting hole 9.
- External wiring harness with fitted ends 10.
- External wiring harness without fitted ends 11.
- Internal wiring harness 12.
- Horn and hardware mounting holes 13.

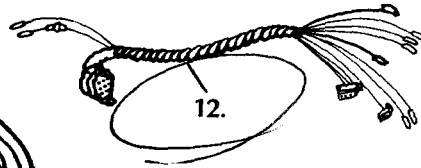
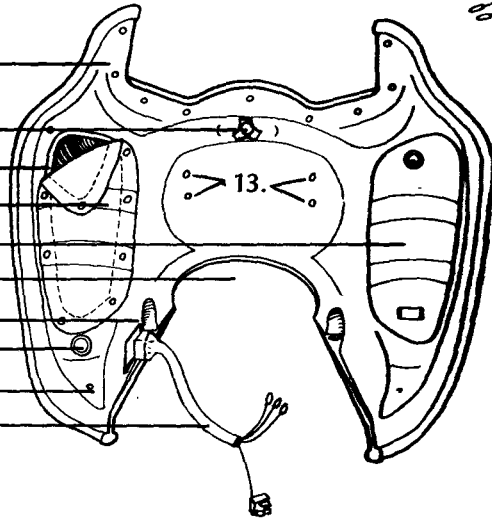

EXTERIOR

- Leading edge light (LEL) 1.
- Windshield 2.
- Windshield foam tape 3.
- LEL socket 4.
- Headlight nacelle 5.
- Sealed beam 6.
- Headlight chrome ring 7.
- Lowers hole plugs 8.
- Chrome vinyl edging 9.
- Nose 10.
- Chin 11.
- Headlight extension 12.
- Standard striping 13.
- Optional color panel insert 14.

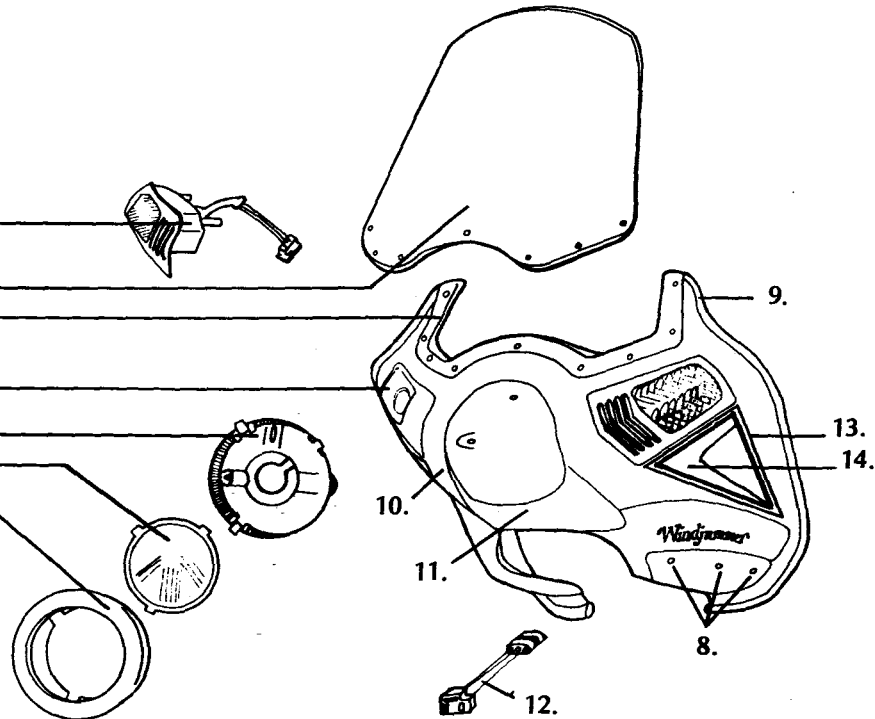

NOTE: All options are dealer or customer installed.

Vindicator II Nomenclature Guide

- INTERIOR**
- Ear 1.
 - Headlight adjustment knob 2.
 - Pocket edging 3.
 - Soft tonneau 4.
 - Hardware Mounting holes 5.
 - Horseshoe 6.
 - Locking tonneau 7.
 - Optional cigarette lighter mounting hole 8.
 - Serial no. plate 9.
 - Lower mounting hole 10.
 - External wiring harness with fitted ends 11.
 - External wiring harness without fitted ends 12.
 - Internal wiring harness 13.

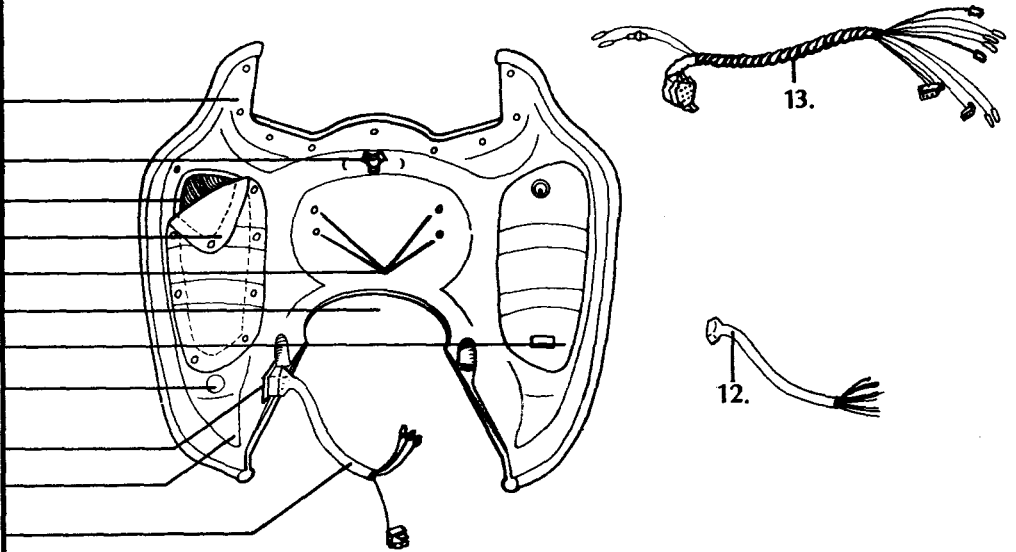

- EXTERIOR**
- Windshield (std.) 1.
 - Windshield foam tape 2.
 - Chrome vinyl edging 3.
 - Headlight nacelle 4.
 - Sealed beam 5.
 - Chrome headlight ring 6.
 - Lowers hold plugs 7.
 - Nose 8.
 - Chin 9.
 - Optional pop vent windshield 10.
 - Headlight extension plug 11.
 - Standard striping 12.
 - Optional color panel insert 13.

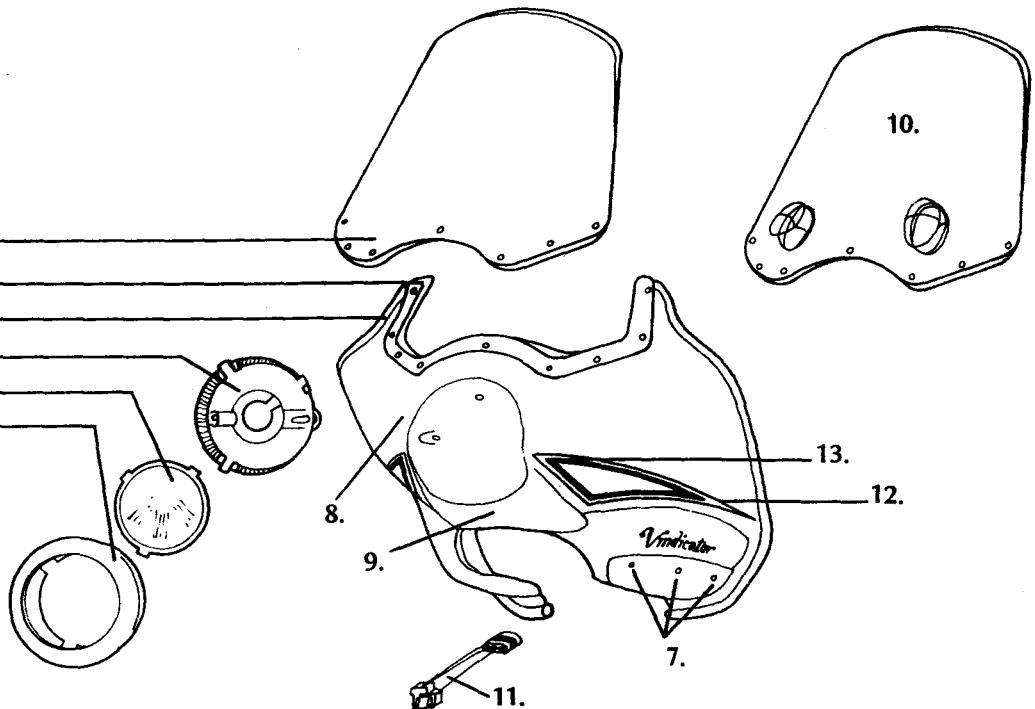

NOTE: All options are dealer or customer installed.

Windshield Installation

After your Vetter fairing hardware has been installed and the fairing has been mounted, the next step is to mount the windshield. There are extensive windshield mounting instructions packaged with the windshield, or you may use the instructions below.

A properly installed windshield is essential for the safe use of the fairing. Seven (7) of the windshield bolts are nylon and over-tightening will result in bolt failures. Please note that the two top fasteners are clips instead of nylon bolts. See the illustration for the assembly sequence.

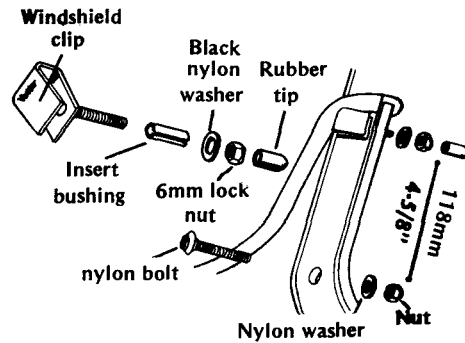

1. Using a nylon bolt, puncture the foam tape at each of the hole locations.
2. The two clips supplied should be positioned on the windshield 118mm (4-5/8") above the upper-most bolt hole on the windshield.

NOTE: For reasons of structural strength, the windshield must be "preloaded" (slightly bent) before the top holes in the fairing will line up with the clip stud.

3. Place the windshield on the fairing, inserting the studs of the clips through the top two fairing holes, and install a black nylon washer and 6mm lock nut on the stud. See illustration.

CAUTION: Surface of the windshield is easily scratched by hard rubbing or rough cloths. DO NOT clean windshield with an abrasive cleaner, ethyl or methyl alcohol, gasoline or solvent, as these materials can cause deterioration of acrylic plastic.

WASH using a soft flannel cloth or chamois and a solution of mild soap or detergent and warm water. Rinse well.

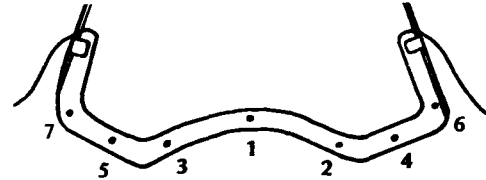

4. For the remaining seven windshield mounting holes:

1. Insert a nylon bolt through the windshield and fairing.
2. Slide a small nylon washer onto each bolt.
3. Install a nut on the bolt but do not tighten at this time.
5. Tighten the bolts with nuts starting with the center bolt and working out. See illustration.
6. If there is any clearance between the windshield and the clip, remove the clip nut and washer and slide one of the provided bushings over the stud and into the fairing hole. This will center the stud in the fairing hole. In some situations, a bushing may be necessary on both sides. See illustration.
7. Install rubber tips over the exposed windshield clip studs.

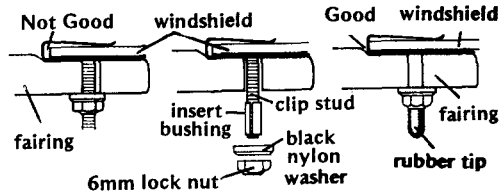

NOTE: If the windshield does not fit tightly in the clips, the foam tape could work out from behind the windshield.

WARNING: Failure to install the windshield properly and maintain bolt tightness may result in windshield cracking. If the windshield ever becomes cracked, it should be replaced for safety reasons.

DRY with a clean soft cloth or chamois.

REMOVE oil, grease or tar with isopropyl alcohol or a good grade of either naphtha or kerosene.

MINOR SCRATCHES may be removed with plastic polish or automotive paste wax. Apply with a clean soft flannel cloth or chamois. Allow to dry and polish gently with dry flannel cloth or chamois.

WINDSHIELD CLEANING INSTRUCTIONS

FOR DEEPER SCRATCHES remove by sanding lightly with 400 grit "wet or dry" paper. Then buff clear with a good grade of fine grit buffing compound and a clean soft muslin wheel. (A ¼" electric drill has sufficient RPM's for this purpose.)

WARNING: Acrylic sheet is a combustible thermo-plastic. Exposure to excessive heat or flame should be avoided. Fire precautions appropriate for other flammable materials

such as wood, should be observed.

! WARNING: READ BEFORE RIDING

Your Vetter windshield is designed to protect you from the elements. It is not intended to protect you in a collision. All windshields can break which may result in rider injury.

Final Adjustments

OBJECTIVE The fairing is now installed but several details must be attended to before the installation is complete.

WARNING: Final clearance adjustment, if neglected, could result in dangerous interferences during use of the fairing and motorcycle. For your safety, make all necessary adjustments before using the newly installed fairing.

A. Check clearances with the fairing and windshield installed to be sure that your headlight does not rub, that your front brake does not engage when turned to full lock positions and that the external wiring harness does not catch anywhere on the motorcycle or fairing when the handlebars are turned. If any of these problems arise, the following steps should solve them.

1. For clearance at the headlight nacelle, tilt the headlight for maximum clearance. If the nacelle is still hitting in that position, remove the bolts that hold the headlight nacelle in position and move it farther back by replacing the bolts with smaller diameter bolts (provided). Finally, on some motorcycles, it may be necessary to remove the headlight nacelle completely. In these cases, use the wire protection cover supplied by Vetter Corporation.

2. Adjust your motorcycle's handlebars and mirrors, if necessary, to provide clearance for maximum turning radius. Loosen the bolts that hold the handlebars and

rotate the handlebars towards the motorcycle, check clearance, then retighten bolts.

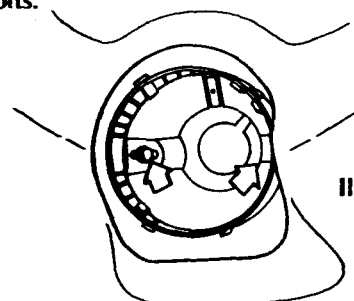

Illus. B

B. Headlight Adjustments

1. Vertical – The fairing has been designed with an adjustable headlight for vertical positioning. The knob located in the center of the dash allows vertical positioning of the beam from the seat of the motorcycle. Readjustment may be necessary when carrying passengers or luggage.

WARNING: Do not adjust the headlight while operating the motorcycle.

2. Horizontal adjustment.

a. Remove the headlight as follows:
1. Using your thumb, push the tab (see illustration A) up until it disengages from ring.

2. Turn the chrome ring counterclockwise to full unlock position and remove.

3. Remove headlight from nacelle and disconnect wiring.

b. Loosen bolt on left side of nacelle until the nacelle is just free to slide fore and aft. (See illustration B).
c. Reinstall headlamp and position nacelle for proper left to right beam position.

d. Carefully remove headlamp without disturbing the nacelle position.

e. Tighten nacelle bolt to lock the nacelle in position.

f. Reinstall headlamp.

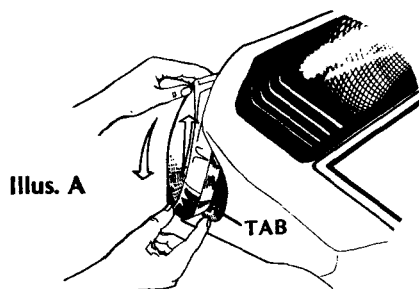

Illus. A

Troubleshooting

ELECTRICAL

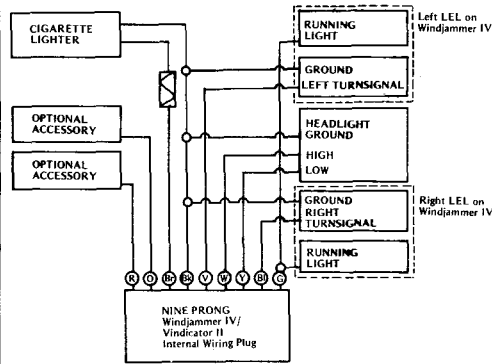

- R-Red – Cigarette lighter
 - O-Orange – Optional Access.
 - Br-Brown – Optional Access.
 - Bk-Black – Ground
 - V-Violet – Left turnsignal
 - W-White – High beam
 - Y-Yellow – Low Beam
 - Bl-Blue – Right turnsignal
 - G-Green – Running Light
- ⊠ fuse 32V, 3 amp
⊠ slow blow

If your problem is electrical, first check your color code to insure the proper wires have been connected. If your colors check out, the next step is to check the blue electrical connectors or bullet connectors (depending

on your model bike) for good contact. This is done by reversing the steps to connect them. Unsnap the lip of the blue connector and remove the metal tab with a pair of pliers. Check both wires to see if the tab cut through the insulation and to the wire itself. Reinsert the wires. A loose bullet connector connection can be improved by unplugging the connector and making the female receptacle smaller by use of pliers and then reinstalling the bullet connector. If no power is getting to the fairing, check to see that the external wiring harness is making a good connection at the fairing's plug. If still no power is getting to the fairing, check the motorcycle's fuses and consult the motorcycle's owner's manual for determining the cause of fuse failure before replacing the fuse. If your headlamp is weak and your turnsignals don't function properly, your ground connection is probably not making good contact, or your battery is weak and needs to be serviced.

If there are any problems that can not be solved by yourself or your dealer, contact the Customer Service Department of Vetter Corporation, Rantoul, IL 61866 (217) 893-9300.

FAIRING MOUNTING

The best answer for almost any problem is to re-read your instructions carefully. If when mounted, your headlamp nacelle rubs your fairing, either the nacelle is not adjusted

back far enough or it is not tilted at the proper angle. Brackets which do not bolt to the motorcycle frame may require up or down adjustment for a proper fit.

WINDSHIELD

If problems arise in mounting the windshield, don't panic. The windshield fits correctly if the proper procedures are followed. In the step-by-step assembly, the proper sequence

for installing the nylon bolts is given. Also, for reasons of structural strength, the windshield must be "preloaded" before it will fit properly.

Maintenance

MAINTENANCE

Vetter fairings require little maintenance, but we recommend that you do make periodic checks. The mounting clamps, mounting

bolts and the windshield fasteners should be checked for tightness and adjustments made as necessary.

CLEANING AND WAXING THE FAIRING AND WINDSHIELD

When washing your fairing, use a mild detergent and warm water. Washing should be done with a soft cloth or sponge. Wash the windshield with the same solution, being careful not to rub or scratch the surface. Waxing the fairing is easy; furniture polish works as well as anything we have found. To finish cleaning the windshield, a plexiglas

cleaner and polisher should be used. Soft flannel cloth is best for the job.

CAUTION: Do not use cleaners which contain methyl or ethyl alcohol.

CAUTION: Hydraulic fluid will damage your Vetter fairing. Never allow it to come in contact with your fairing.

STRUCTURAL REPAIR

Structural damage to the fairing may be repaired by using a Hotcha Fix Kit available through your dealer. The Hotcha Fix Kit includes Resin and Cream Hardener, plastic fairing material, stir sticks and instructions for using the kit. Regular automotive body putty can be used to prepare the surface of

the fairing for painting.

Because certain substances can attack the fairing body and cause it to deteriorate, we do not advise using any materials other than the Hotcha Fix Kit and automotive body putty.

IMPORTANT DRILLING INSTRUCTIONS

When mounting accessory lights, brackets, etc., be sure to pad each side of the fairing with an oversize rubber washer first, then regular steel washers.

CAUTION: Failure to follow this procedure can result in failure at the mounting hole.

FAIRING STRIPING REMOVAL

When removing striping from the fairing, we suggest you use either our 3M Striping Removal Kit or use 3M Woodgrain and Striping Remover, part number, 18907, followed by 3M Adhesive Remover, part number, 18908. These products can be obtained at most paint and automotive stores that carry 3M products. Please follow the directions on the spray cans explicitly. These are very strong chemicals and can harm the paint if not used properly. We suggest removing the fairing from the motorcycle and trying the remover first on the hardware rail area. If the remover is defective and harms the paint, it will be in a place that will not show.

CAUTION: Be sure to shield the leading edge lights, or remove them entirely from the fairing, because 3M Striping Remover will remove the black paint from the LEL's. Vetter cannot be responsible for 3M products.

When handling striping, do not crease or bend it. Always handle striping from the edges, never from the ends. Do not pull the backing off the striping with the expectations of reapplying it. Backing paper will NOT restick. If you have any questions on storing, handling, removal or application of striping that your dealer cannot answer, contact our Customer Service Department.

PAINTING INSTRUCTIONS

If you desire to repaint your fairing, we recommend that the following instructions be used.

1. Remove fairing logo decal and stripes.
2. Sand thoroughly with 320 grit wet sandpaper.

3. Resand with 400 grit wet sandpaper.
4. Dry thoroughly.
5. Spray with DuPont 100S Multi Purpose Primer.
6. Spray DuPont Weight Lifter Acrylic Enamel with 792S or 793S Hardener.
7. Install new vinyl decals.

QUARTZ HEADLIGHT (optional)

When handling the quartz bulb, handle it by the base only. Do not touch the glass, as this can cause premature failure. If the bulb is

touched, clean using isopropyl alcohol with clean cotton.

TONNEAU COVERS

The locking tonneau cover must not be removed while operating the motorcycle, because of the possibility that the wind could catch it and bind the handlebars. If the cover is too snug or too loose, bend the lock blade or tab at the bottom of the tonneau cover to achieve the desired fit.

The pocket flap's double snaps are directional which necessitates that the cover be removed from the top down and put on from the bottom up. Care should be taken when removing the pocket tonneau cover so as not to pull the snaps out of the fairing or the cover itself.

TOWING

When trailering or towing your motorcycle it is advisable to remove the windshield from

the fairing. Turbulent air from the towing vehicle could possibly rip the windshield off.

REPLACEMENT PARTS

We recommend that you always use Genuine Vetter Replacement Parts or their equivalent.

Contact your local Vetter dealer to purchase or order replacement parts.

CUSTOMER SERVICE

Any problems concerning installation or modification of the fairing should be referred to your dealer or the Customer Service Department, Vetter Corporation, Rantoul, IL 61866. We are here to serve you — (217) 893-9300. In order to provide the maximum amount of service to you and the dealer, it is necessary that

you fill out the Owner's Registration Card and promptly return it to Vetter Corporation. We also suggest you record your fairing's serial number here:

so you will have it should you ever need to contact us. It is located at the left interior plate where the wiring harness plugs in.

LIMITED WARRANTY VETTER CORPORATION PRODUCTS

This Warranty applies to products manufactured or distributed by Vetter Corporation, Rantoul, IL 61866, (217) 893-9300, and sold by Vetter Corporation or its authorized dealers within the United States, Puerto Rico, and the Virgin Islands. It is given to the first retail purchaser only and is not transferable to subsequent owners.

WARRANTY OBLIGATION: Vetter Corporation warrants that it, or one of its authorized dealers, will repair or, at its option, replace any part proven to be defective in factory material or workmanship within six (6) months (unlimited mileage) of the date of purchase. Parts repaired or replaced under this warranty are warranted only during the balance of the original warranty period. **THIS WARRANTY DOES NOT INCLUDE ANY LABOR CHARGES FOR TROUBLESHOOTING, REMOVAL OR INSTALLATION.**

Exclusions from Coverage: 1. Any repairs or replacements or parts necessitated by misuse, negligence, fire, accident, damage caused by exposure to gasoline, brake fluid, harmful solvents and cleaners, paints, or repair material, use of unauthorized accessories, faulty installation, installation upon motorcycles or vehicles not listed in Vetter Corporation's retail and dealer catalog sheets, or improper or unreasonable maintenance are not covered. 2. This warranty does not cover "Totes" rainboots.

DISCLAIMER OF CONSEQUENTIAL DAMAGES AND LIMITATIONS OF IMPLIED WARRANTIES: TO THE EXTENT THE LAW PERMITS, VETTER CORPORATION SHALL NOT BE LIABLE UNDER ANY CIRCUMSTANCES FOR LOSS OF USE OF THE PRODUCT, CONSEQUENTIAL OR INCIDENTAL DAMAGES. ANY IMPLIED

WARRANTY ARISING UNDER LAW, INCLUDING THOSE OF MERCHANTABILITY AND FITNESS FOR A PARTICULAR PURPOSE IS LIMITED TO THE DURATION OF THIS LIMITED WARRANTY.

IMPORTANT: Some states do not allow limitations on how long an implied warranty lasts and/or limitations or exclusions of consequential or incidental damages, so the above limitations may not apply to you.

To Obtain Warranty Service: Information you must provide when filing claim: 1. Name, mailing address and telephone number. 2. Selling dealer's name and address. 3. Serial number on serialized products. 4. Model and year of motorcycle. 5. Date product was purchased. 6. Date and mileage at failure. 7. Description of problem.

Steps to take: 1. Contact or take your product to an authorized Vetter dealer (preferably your selling dealer) at your expense. 2. If you are unable to obtain warranty service, or should your warranty claim be denied for reasons that you consider unjustifiable, contact the owner of your selling dealer. Normally, this should resolve your problem. However, if you require further assistance, write or call the Customer Service Department of Vetter Corporation, Rantoul, IL 61866. (217) 893-9300. At this point, you must be prepared to return the part in question to Vetter Corporation with all freight charges prepaid. The charges will be reimbursed to you if they total over \$5.00 (five dollars) and the warranty claim is honored. This warranty gives you specific legal rights and you may also have other rights which vary from state to state.

September 30, 1979
Vetter Corporation

